

RUGGED.

DOCKING STATIONS AND VEHICLE MOUNTS



MCS Vehicle Leg Kit: Ford F-150 (2004-2008)

Placement	Seat Configuration	Drilling Required	Weight
On top of transmission hump	Bucket	No - required removal of center console & attaches to console mounting points	4.0 lbs

Features

- Heavy gauge steel construction for long-term durability
- Black powdercoat finish for maximum corrosion resistance
- Legs attach to both short and long *MCS Top Plates* (Item No. 7160-0085 or 7160-0086)

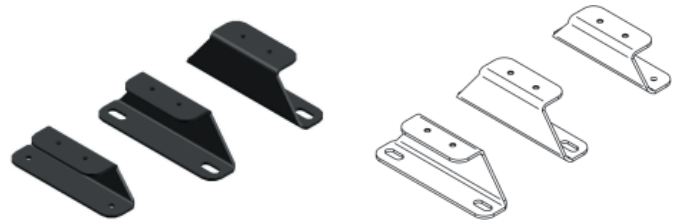

Item No. 7160-0076



3001 Borham Ave
Stevens Point, WI 54481
Phone: 800-456-6868
Fax: 715-344-8845

Email: gamberj@gamberjohnson.com
Website: www.gamberjohnson.com